



The ZBVT ball valve coupled with the ZMRA proportional actuator has been designed for AHU or fan-coil control of heating and cooling systems. The actuator is using high durable bi-directional motor and can be used for proportional control of the ZBVT ball valve delivering high closed off pressure rating.

- Low cost
- No leakage
- Valve & actuator can be installed separately
- High torque actuator
- High working pressure of 25 bar
- Equal percentage characteristic
- Close-off rating approximately 6 bar
- Bi-directional AC motor
- Proportional control
- Built-in micro-switch for power saving
- With manual override
- High control precision and sensitivity
- Low noise level
- Fireproof ABS engineering plastic, to UL94V-0 standard
- Detachable design, easy to install and maintain

Models

2-way	3-way	Connection	Kv	+Pc
ZBTV215/4	ZBVT315/4	DN15	4	600kPa
ZBTV220/6.3	ZBVT320/6.3	DN20	6.3	600kPa
ZBTV225/10	ZBVT325/10	DN25	10	600kPa
ZBTV232/16	ZBVT332/16	DN32	16	600kPa
ZBTV240/25	ZBVT340/25	DN40	25	600kPa
ZBTV250/40	ZBVT350/40	DN50	40	600kPa

ZMRA-024E04 0-10vdc proportional actuator, 24 VAC operation.

ZMRA-024D04 0-10vdc proportional actuator, 24 VAC operation with LED display.

Technical data

Valve

Valve type.....2/3 way ball valve
 Pressure class.....PN 25 (360 psi)
 Fluid temperature.....2°C to 94°C
 Working media..... Chilled/hot water; 50% glycol
 Leakage.....none
 Valve body.....forged brass
 Ball.....Casting brass (nickel-plated)
 Ball Sealing..... PTFE
 Stem.....stainless steel
 Seal.....NBR

Actuator

Supply voltage.....24VAC +/- 10%
 Power consumption.....5 VA
 Control signal.....0-10Vdc or 4-20mA
 Ambient operating temperature0 to 40°C
 Torque.....>= 5 Nm
 Operation time.....57secs(50Hz/90°)
 Weight.....0.46 kg
 Chassis & cover.....polycarbonate/ABS engrg plastic
 Gear.....POM (polyoxymethylene) + brass
 Reducer Plate.....stainless steel plate

Dimensions

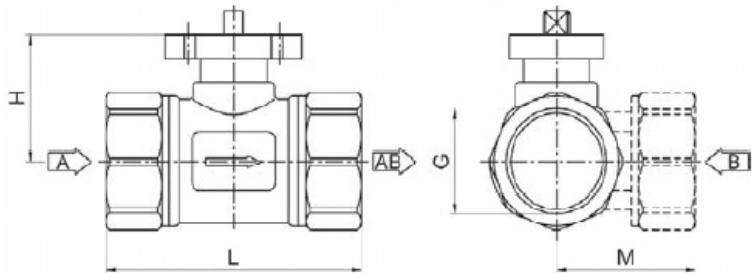
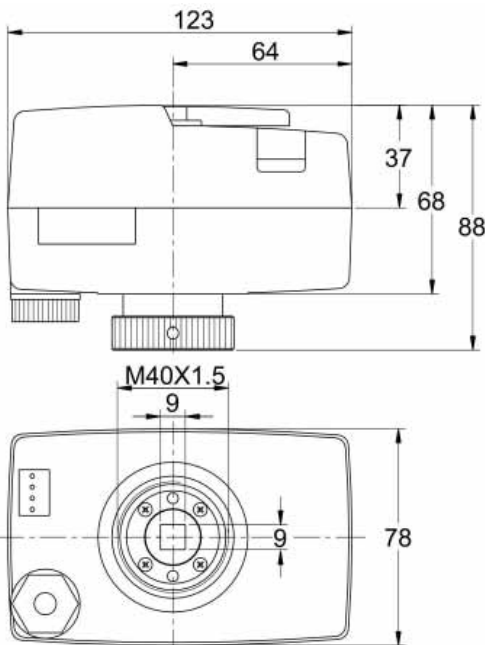

DIMENSIONS (MM)

DN mm	DIMENSIONS			THREAD G	MAX. PIPE SIZE
	L	H	M (3-WAY)		
15	68	32	46	1/2"	13
20	68	32	46	3/4"	13
25	82	37	57	1"	17
32	98	48	50	1 1/4"	19

Wiring, Manual Switch, Assembly & Disassembly

