



The ZBVT ball valve coupled with the Z3PRA rotary actuator has been designed for AHU or fan-coil control of heating and cooling systems. The actuator is using high durable bi-directional motor and can be used for on-off function or 3-position control of the ZBVT ball valve delivering high closed off pressure rating.

- Low cost
- No leakage
- Valve & actuator can be installed separately
- High torque actuator
- High working pressure of 25 bar
- Two KVs to choose from
- Close-off rating approximately 6 bar
- Bi-directional AC motor
- On/off type or floating type
- Built-in micro-switch for power saving
- With manual override
- High control precision and sensitivity
- Low noise level
- Fireproof ABS engineering plastic, to UL94V-0 standard
- Detachable design, easy to install and maintain

Models

2-way	3-way	Connection	Kv	+Pc
ZBTV215FP012	ZBVT315FP012	DN15	12	600kPa
ZBTV215EQ004	ZBVT315EQ004	DN15	4	600kPa
ZBTV220FP015	ZBVT320FP015	DN20	15	600kPa
ZBTV220EQ006	ZBVT320EQ006	DN20	6.3	600kPa
ZBTV225FP022	ZBVT325FP022	DN25	22	600kPa
ZBTV225EQ010	ZBVT325EQ010	DN25	10	600kPa
ZBTV232FP034	ZBVT332FP034	DN32	34	600kPa
ZBTV232EQ16	ZBVT332EQ16	DN32	16	600kPa
ZBTV240FP032	ZBVT340FP032	DN40	32	600kPa
ZBTV240EQ025	ZBVT340EQ025	DN40	25	600kPa
ZBTV250FP050	ZBVT350FP050	DN50	50	600kPa
ZBTV250EQ040	ZBVT350EQ040	DN50	40	600kPa

Technical data

Valve

Valve type.....2/3 way ball valve
 Pressure class.....PN 25 (360 psi)
 Fluid temperature.....2°C to 94°C
 Working media..... Chilled/hot water; 50% glycol
 Leakage.....none
 Valve body.....forged brass
 Ball.....Casting brass (nickel-plated)
 Ball Sealing..... PTFE
 Stem.....stainless steel
 Seal.....NBR

Actuator

Supply voltage.....230VAC +/- 10%
 Power consumption.....5 VA
 Control signal.....0n-off or 3-point
 Ambient operating temperature0 to 40°C
 Torque.....>= 5 Nm
 Operation time.....57secs(50Hz/90°)
 Weight.....0.46 kg
 Chassis & cover.....polycarbonate/ABS engrg plastic
 Gear.....POM (polyoxymethylene) + brass
 Reducer Plate.....stainless steel plate

Dimensions

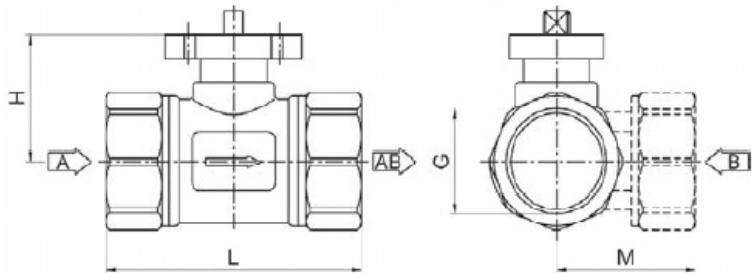
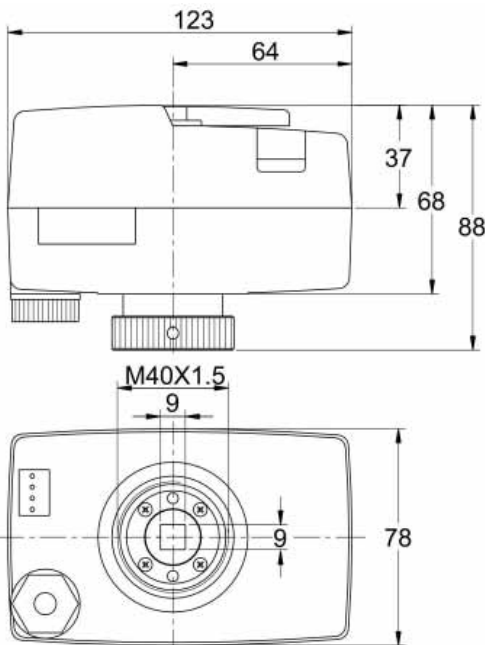

DIMENSIONS (MM)

DN mm	DIMENSIONS			THREAD G	MAX. PIPE SIZE
	L	H	M (3-WAY)		
15	68	32	46	1/2"	13
20	68	32	46	3/4"	13
25	82	37	57	1"	17
32	98	48	50	1 1/4"	19

Wiring, Manual Switch, Assembly & Disassembly

